



134 Longueville Road Lane Cove NSW

Prominent highly visible, high street location with constant foot and vehicle traffic, located in bustling affluent suburb.

Excellent staff breakout area with male and female amenities, kitchen and additional storage. Ducted A/C and cabling remain from bank.

Tandem 3 car parking, two undercover via rear access.

Net Lettable area of 244.4m²

Three levels

Ground - 173.4m²

lower ground - 55.1m²

Basement - 15.9m²

Building Size : 244 sqm

View

: <https://www.redproperty.com.au/lease/nsw/north-shore-lower/lane-cove/commercial/retail/7641669>



David Ryals
02 9977 7533

LETTABLE AREA PLAN FOR 134 LONGUEVILLE ROAD, LANE COVE, NSW

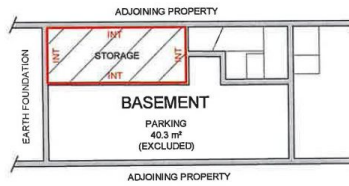
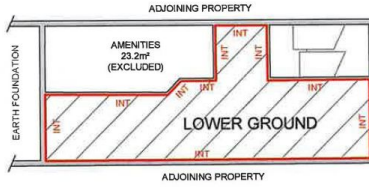

INT - INTERNAL FACE
GL - GLASS LINE
LTP - LINE OF TENANCY PRODUCED
C/C - CENTRELINE OF COLUMN



SCHEDULE OF AREAS

BASEMENT	15.9 m ²
LOWER GROUND	55.1 m ²
GROUND	173.4 m ²
TOTAL AREA	244.4 m²

LETTABLE AREA



METHOD OF MEASUREMENT

AREAS HAVE BEEN CALCULATED IN ACCORDANCE WITH THE PROPERTY COUNCIL OF AUSTRALIA (PCA) METHOD OF MEASUREMENT FOR LETTABLE AREA (MARCH 1997)
(SURVEY DATE 20/02/2018)

GUIDELINES USED

GROSS LETTABLE AREA - RETAIL

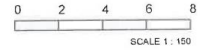

PLAN PREPARED FOR:

WESTPAC

LETTABLE AREA PLAN
134 LONGUEVILLE ROAD,
LANE COVE, NSW

DATE: 20/02/2018

REF: 66343

REV: -

DRAWN: BK

CHECKED: CL

SCALE: 1:150 @ A3

SHEET: 1 of 1

Australia | New Zealand

REALSERVE

Building Measurement Specialist
Consulting Land Surveyors
3D Laser Scanning

ph. 02 9629 9377
www.realserve.com.au